



HO

EXKLUSIVES VILLEN PROJEKT
BEI ESENTEPE
2- BZW. 3 BR AB 445.000 GBP
FERTIGSTELLUNG 07/24





NºHO





NºHO





NºHO





NºHO



NºHO

BLOCK A								
The Type	Gross Area m2	Closed Terrace m2	Open Terrace m2	Pool Size m2	plot Size m2	Total Size m2	Prices*	Status
A1	133	15	30	240	194	175	£480,000	
A 2	133	15	30	240	145	175		RESERVED
A 3	133	15	30	240	200	175		SOLD
A 4	133	15	30	70	280	175	£549,000	Available
A 5	133	15	30	82	242	175	£549,000	Available
A 6	133	15	30	140	182	175		RESERVED
A 7	133	15	30	140	140	175	£445,000	Available
A 8	133	15	30	135	140	175	£445,000	Available
A 9	133	15	30	135	197.5	175		SOLD
A 10	133	15	30	77	236	175		RESERVED
A 11	133	15	30	80	235	175		SOLD
A 12	133	15	30	80	246	175		SOLD
A 13	133	15	30	65	256	175	£489,000	Available
A 14	133	15	30	150	261	175	£489,000	Available
A 15	133	15	30	150	172	175	£489,000	Available
A 16	133	15	30	83	155	175	£489,000	Available
A 17	133	15	30	80	155	175	£489,000	Available
A 18	133	15	30	60	173	175		RESERVED
A 19	133	15	30	83	300	175		SOLD
A 20	133	15	30	73	200	175		RESERVED

BLOCK B								
The Type	Gross Area m2	Closed Terrace m2	Open Terrace m2	Pool Size m2	plot Size m2	Total Size m2	Prices*	Status
B1	133	15	30	33	350	175		PENCIL RESERVED
B2	133	15	30	33	295	175	£609,000	Available
B 3	133	15	30	33	392	175	£609,000	Available
B 4	133	15	30	33	360	175	£609,000	Available
B 5	133	15	30	33	292	175	£609,000	Available
B 6	133	15		Jacuzzi	324	175	£589,000	Available
B 7	133	15		Jacuzzi	240	175	£589,000	Available
B 8	133	15		Jacuzzi	251	175	£589,000	Available
B 9	133	15		Jacuzzi	245	175	£589,000	Available
B 10	133	15		Jacuzzi	230	175		RESERVED

BLOCK D								
The Type	Gross Area m2	Closed Terrace m2	Open Terrace m2	Pool Size m2	plot Size m2	Total Size m2	Prices*	Status
D1	133	15	19.7	33	201	175	£689,000	Available
D 2	133	15	19.7	33	211	175	£689,000	Available
D 3	133	15	19.7	33	375	175	£689,000	Available
D 4	133	15	19.7	33	272	175	£689,000	Available
D 5	133	15	19.7	33	249	175	£689,000	Available
D 6	133	15	19.7	33	265	175		PENCIL RESERVED
D 7	133	15	19.7	33	249	175	£689,000	Available
D 8	133	15	19.7	33	282	175	£689,000	Available
D 9	133	15	19.7	33	242	175	£689,000	Available
D10	133	15	19.7	33	267	175		RESERVED

NºHO

BLOCK C								
The Type	Gross Area m2	Closed Terrace m2	Open Terrace m2	Pool Size m2	plot Size m2	Total Size m2	Prices*	Status
C1	185	92	55.2	34	92.5	332.2	£1,700,000	Available

Important Note:

The reservation fee for 2 weeks is **5,000 GBP**. After a %35 Down payment you can have 3 options for your payment plan:

1. Complete your payment until the end of 2024 with **no interest**.
2. Get a 70% Interest-free payment until the end of 2024 and 30% over 2 years with 2,5% interest.
3. Pay a 50% downpayment (Instead of %35) and enjoy a **GBP 15,000 discount!** the rest 50% and be paid **Interest-free** until the end of 2024.

All of your payments are protected by a **Bank guarantee**.

Units that are marked **Blue** have **pool included** in their prices, and units marked **Purple** have a **Jacuzzi included** in their price.

VRF (Airconditioning unit) and **Vestel white goods** are included in the prices.

Total construction area of the project is 5344 m2 | Total land area of the projects is 18,876 m2



NºHO

HORIZON VILLA



- Gross: 133 m2
- Close Terrace: 15m2
- Open Terrace: 30 m2
- Pool: 33 - 150 m2
- Land: 140 - 375 m2
- Optional: Firepit Or Jacuzzi

2 Bedrooms Setup (2+1)



Scan
to watch the
Status Update
Video



3 Bedrooms Setup (3+1)



HORIZON VILLA



- Gross: 133 m2
- Close Terrace: 15m2
- Open Terrace: 30 m2
- Pool: 33 - 150 m2
- Land: 140 - 375 m2
- Optional: Firepit Or Jacuzzi

NºHO

PREMIUM VILLA



Indoor living area: 185m²

Basement: 92m²

Terraces: 55,2m²

Pool: 34m²

Total living: 332,2m²

Land: 925 m²

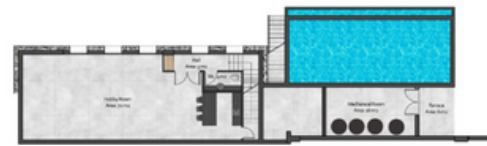

Quality Standards



- The developer of Horizon emphasizes **high quality**.
- "We deliver outstanding quality and **much higher quality than the standard.** "
- Buildings are made with the **highest quality materials**. Steel and concrete used for the project are sampled and **stress tested**.
- Furniture and electrical devices are of **premium quality**.

NºHO

FERTIGSTELLUNG 07/24

- CA. 10 MIN. ZUM GOLFPLATZ, CA. 30 MIN. NACH GIRNE
- 41 VILLEN BAUPROJEKT, RUHIG GELEGEN
- IN STRANDNÄHE GELEGEN
- TOP-LAGE MIT WUNDERSCHÖNEM MEER- UND BERGBLICK
- INKL. KLEIDERSCHRÄNKE, HOCHWERTIGE INNENAUSSTATTUNG
- INKL. EINBAUKÜCHE UND WHITE GOODS
- INKL. AIRCON & HEATING
- INKL. MOBILAR
- GENERATOR UND SECURITY KAMERAS
- SNACKBAR AUF DEM GELÄNDE
- SUPERMARKT UND RESTAURANTS IN UNMITTELBARER NÄHE
- FLUGHAFEN LARNACA CA. 1,5 STD. / ERCAN CA. 45 MIN.
- VERMIETSERVICE WIRD ANGEBOTEN

NºHO



MELDE DICH JEDERZEIT
GERNE BEI UNS FÜR:

- VERFÜGBARKEITEN
- GRUNDRISSE
- PREISE
- PAYMENT PLANS
- WEITERE INFOS

WIR FREUEN UND AUF
DICH! DEIN NZ-TEAM

INFO@IMMOBILIE-
NORDZYPERN.
KAUFEN

+49 1573 1901919

IMMOBILIE
AM MEER

NZ
NORDZYPERN